



MIDLAND
COUNTY ROAD COMMISSION
2334 N. MERIDIAN ROAD
SANFORD, MI 48657

Phone (989) 687-9060
Fax (989) 687-9121
www.midlandroads.com

NOTICE TO BIDDERS
ADDENDUM #1 – January 8, 2019
Eastman Road Scrap Tire Grant Project

Item #1:

5017031 _HMA, 4E1, GRT revise quantity from 430 Ton to **661** Ton
5017031 _HMA, 5E1, GRT revise quantity from 1,549 Ton to **2,382** Ton

- Find attached **BlankBidSheet_Revised 1_8_19** and replace pages 1-6 of the proposal (updated HMA quantities).
- Find attached **Revised plan sheets_11_14_29_38** and replace with corresponding plan sheets (updated HMA quantities).

Item #2:

Find attached **HMA Alternate Bid**. Provide pricing accordingly. These items are an “alternate” and shall not be included in the Total Bid for the project.

Item #3:

Find attached **402 Dr Structure_inch Tee Riser_Revised 2019-01-08** and replace with corresponding page (13) in proposal.

Item #4:

For **Sewer, CL E, __** and **Culv, CL E, __**

- Smooth-Lined Corrugated Plastic Pipe **IS** allowable, all diameters up to and including 60 in, provided at least 2 ft of cover.
- Smooth-Lined High-Performance Polypropylene Pipe meeting ASTM F2881 is allowable, all diameters up to and including 60 in, provided at least 1 ft of cover.

Item #5:

For **Sewer Tap, __ inch**, connections to plastic pipe shall be **INSERTA TEE** or approved equal.

Item #6:

For **Culv End Sect, __** shall be metal or concrete. **NO** plastic end sections shall be allowed.

Midland County Road Commission

Schedule of Items (Itemized Bid Sheet)

Letting Date: Thursday, January 24, 2019 1:00 PM

Contract ID: 5025-17-0120
Location: Eastman Road Mier Road to South of Schneider Court
Description: HMA mill and resurface, shoulder widening, ditch & drainage improvements, tire derived aggregate subbase, pavement marking and signing.

Project Number:	CO-175056	Project Engineer:	John Kelley
Estimate Number:	3	Date Created:	12/21/2018
Project Type:	Resurfacing	Fed/State #:	
Location:	Eastman Road	Fed Item:	
	Mier Road to South of Schneider Court	Control Section:	885901
Description:	HMA mill and resurface, shoulder widening, ditch & drainage improvements, tire derived aggregate subbase, pavement marking and signing.		

Instructions to Bidders: IMPORTANT NOTICE:

The undersigned understands and agrees that the local agency reserves the right to reject any and all bids and no contractual relationship shall exist between the undersigned and the local agency for the work described herein until such time as award is formally given.

The undersigned agrees upon submitting this bid that its agents, officers or employees have not directly or indirectly entered into any agreements, participated in any collusion, or otherwise taken any action in restraint of free competitive bidding in connection with this proposal for the above project.

Subject to Section 102.17 of the MDOT Standard Specifications for Construction, the undersigned agrees to pay to the Midland County Road Commission (Local Agency) the proposal guaranty sum of: \$25,000.00, if the undersigned fails to provide the required materials and/or execute the contract in accordance with Section 102.15 of the MDOT Standard Specifications for Construction within twenty-eight (28) days after being furnished with necessary contract and bond forms. The Local Agency may, upon request by the undersigned based on valid considerations and made prior to expiration of the twenty- eight (28) day period, extend said period of time as the Local Agency may deem appropriate. A written request for return, or cancellation, of the proposal guaranty under Section 102.17 of the MDOT Standard Specifications for Construction must be filed with the Local Agency within fifteen (15) days after mailing by the Local Agency of notice that the proposal guaranty is being forfeited. Upon an adverse decision by the committee or failure to file a timely request for return, or cancellation, of proposal guaranty, payment shall be made within 20 days after the mailing by the Local Agency of a Final Demand for Payment. If payment is not made within 20 days, the undersigned hereby authorizes the Local Agency to withhold said sum from any money which may now, or hereafter, become due and owing by the Local Agency to the undersigned.

COMPANY BIDDING _____

CONTACT PERSON _____

ADDRESS _____

PHONE/FAX _____

AUTHORIZED SIGNATURE

TITLE

INDICATE ON ENVELOPE: Company Name, Bid Item, Time and Date

Pay Item	Description	Quantity	Units	Unit Price		Bid Amount	
				Dollars	Cts	Dollars	Cts
1500001	Mobilization, Max	1	LSUM				
2030001	Culv, Rem, Less than 24 inch	28	Ea				
2030002	Culv, Rem, 24 inch to 48 inch	10	Ea				
2030003	Culv, Rem, Over 48 inch	4	Ea				
2030011	Dr Structure, Rem	3	Ea				
2030015	Sewer, Rem, Less than 24 inch	174	Ft				
2030016	Sewer, Rem, 24 inch to 48 inch	245	Ft				
2050010	Embankment, CIP	3,000	Cyd				
2057002	_ Machine Grading, Modified	84.77	Sta				
2080036	Erosion Control, Silt Fence	500	Ft				
3017021	_ Subbase, TDA	3,028	Cyd				
3020016	Aggregate Base, 6 inch	11,068	Syd				
3060020	Maintenance Gravel	100	Ton				
3070021	Approach, CI II	175	Ton				
3070121	Shoulder, CI II	632	Ton				
3070200	Trenching	169.54	Sta				
4010012	Culv End Sect, 12 inch	14	Ea				
4010015	Culv End Sect, 15 inch	3	Ea				
4010018	Culv End Sect, 18 inch	6	Ea				
4010036	Culv End Sect, 36 inch	1	Ea				
4010055	Culv End Sect, Conc, 48 inch	2	Ea				
4010057	Culv End Sect, Conc, 60 inch	2	Ea				

Pay Item	Description	Quantity	Units	Unit Price		Bid Amount	
				Dollars	Cts	Dollars	Cts
4010059	Culv End Sect, Conc, 72 inch	2	Ea				
4010102	Culv End Sect, Metal, 48 inch	1	Ea				
4010131	Culv, CI A, 12 inch	69	Ft				
4010546	Culv, CI E, 48 inch	58	Ft				
4010548	Culv, CI E, 60 inch	41	Ft				
4010550	Culv, CI E, 72 inch	46	Ft				
4020004	Sewer, CI A, 12 inch, Tr Det A	31	Ft				
4020008	Sewer, CI A, 30 inch, Tr Det A	593	Ft				
4020009	Sewer, CI A, 36 inch, Tr Det A	1,283	Ft				
4020033	Sewer, CI A, 12 inch, Tr Det B	48	Ft				
4020036	Sewer, CI A, 24 inch, Tr Det B	119	Ft				
4020040	Sewer, CI A, 48 inch, Tr Det B	68	Ft				
4020605	Sewer, CI E, 36 inch, Tr Det B	89	Ft				
4021200	Sewer Tap, 4 inch	4	Ea				
4021201	Sewer Tap, 6 inch	3	Ea				
4021204	Sewer Tap, 12 inch	2	Ea				
4030040	Dr Structure Cover, Type G	19	Ea				
4030200	Dr Structure, 24 inch dia	1	Ea				
4030210	Dr Structure, 48 inch dia	14	Ea				
4030220	Dr Structure, 60 inch dia	3	Ea				
4030231	Dr Structure, 84 inch dia	1	Ea				
4030290	Dr Structure, Cleaning	1	Ea				

Pay Item	Description	Quantity	Units	Unit Price		Bid Amount	
				Dollars	Cts	Dollars	Cts
4030315	Dr Structure, Tap, 15 inch	1	Ea				
4037050	_ Dr Structure, 12 inch Tee Riser	16	Ea				
4037050	_ Dr Structure, 15 inch Tee Riser	4	Ea				
4037050	_ Dr Structure, 18 inch Tee Riser	4	Ea				
4037050	_ Dr Structure, 24 inch Tee Riser	2	Ea				
4037050	_ Dr Structure, 30 inch Tee Riser	2	Ea				
4037050	_ Dr Structure, 36 inch Tee Riser	5	Ea				
4047001	_ Underdrain, Pipe, 12 inch	6,285	Ft				
4047001	_ Underdrain, Pipe, 15 inch	765	Ft				
4047001	_ Underdrain, Pipe, 18 inch	1,900	Ft				
4047001	_ Underdrain, Pipe, 24 inch	930	Ft				
4047001	_ Underdrain, Pipe, 4 inch	900	Ft				
5010002	Cold Milling HMA Surface	1,059	Syd				
5010005	HMA Surface, Rem	1,556	Syd				
5017031	_ Hand Patching, GRT	166	Ton				
5017031	_ HMA Approach, GRT	224	Ton				
5017031	_ HMA, 4E1, GRT	661	Ton				
5017031	_ HMA, 5E1, GRT	2,382	Ton				
8070095	Post, Mailbox	20	Ea				
8100371	Post, Steel, 3 lb	369	Ft				
8100397	Sign, Type II, Rem	3	Ea				
8100398	Sign, Type IIA	26	Sft				

Pay Item	Description	Quantity	Units	Unit Price		Bid Amount	
				Dollars	Cts	Dollars	Cts
8100403	Sign, Type III, Rem	8	Ea				
8100404	Sign, Type IIIA	38	Sft				
8100405	Sign, Type IIIB	25	Sft				
8100421	Sign, Type V, Rem	5	Ea				
8100425	Sign, Type VB	31	Sft				
8110231	Pavt Mrkg, Waterborne, 4 inch, White	16,588	Ft				
8110232	Pavt Mrkg, Waterborne, 4 inch, Yellow	3,925	Ft				
8110251	Pavt Mrkg, Waterborne, 2nd Application, 4 inch, White	16,588	Ft				
8110252	Pavt Mrkg, Waterborne, 2nd Application, 4 inch, Yellow	3,925	Ft				
8120170	Minor Traf Devices	1	LSUM				
8120370	Traf Regulator Control	1	LSUM				
8130011	Riprap, Plain	68	Ton				
8167011	_ Slope Restoration, Modified	24,542	Syd				
8210001	Monument Box	4	Ea				
8210010	Monument Preservation	4	Ea				
8230096	Hydrant, Relocate, Case 2	4	Ea				
8230432	Gate Box, Adj, Case 2	4	Ea				

Pay Item	Description	Quantity	Units	Unit Price		Bid Amount	
				Dollars	Cts	Dollars	Cts
Total Bid:							

DRAWING PATH: P:\5000_5499\5025170120_Eastman_Road_Scrap_Tire_GrantDrawings\ChpPlans_Constr\170120CON.01.dwg Jan 08, 2019 - 1:02:26am

EASTMAN ROAD
(66' R.O.W.)

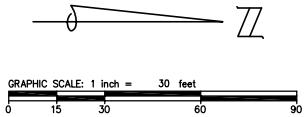

ARCHITECTS ENGINEERS PLANNERS

415 E Main St
Midland, MI 48640
P (989) 956-2020

OHM-ADVISORS.COM

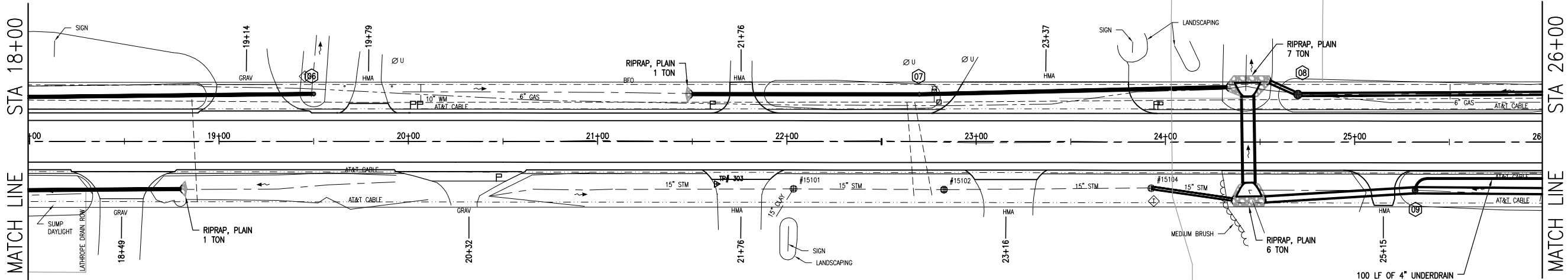

STATION		BACK OF DRIVE OFFSET FROM ALI	OPENING WIDTH (@ BACK OF PAVED SHLDR)	PROPOSED DRIVEWAY SLOPE	RADIUS		HMA Approach	Aggregate Base, 6 inch	Approach, CI II
					ENTER	EXIT			
18+49	RT	30.0	56.0	-1.8%	20	20	-	-	Ton
19+14	LT	30.0	60.0	-6.3%	20	15	-	-	11
19+79	LT	20.0	30.0	1.2%	10	10	3	7	-
20+32	RT	21.0	70.0	7.8%	200	200	-	-	5
21+76	RT	20.0	43.0	3.8%	20	20	4	11	-
21+76	LT	31.0	37.0	-1.1%	15	10	6	23	-
23+16	RT	20.0	43.0	-2.0%	15	15	4	12	-
23+37	LT	31.5	119.0	1.9%	15	25	34	152	-
25+15	RT	33.5	37.0	-0.9%	15	10	6	26	-
TOTALS							56	232	26

QUANTITIES THIS SHEET		
TOTAL	UNIT	DESCRIPTION
252	Cyd	Subbase, TDA
970	Syd	Aggregate Base, 6 inch
49	Ton	Shoulder, CI II
3	Ea	Culv End Sect, 12 inch
1	Ea	Culv End Sect, 15 inch
1	Ea	Culv End Sect, 18 inch
1	Ea	Culv End Sect, 36 inch
2	Ea	Culv End Sect, Conc, 72 inch
46	Ft	Culv, CI E, 72 inch
147	Ft	Sewer, CI A, 36 inch, Tr Det A
1	Ea	Sewer Tap, 4 inch
1	Ea	Dr Structure Cover, Type G
1	Ea	Dr Structure, 48 inch dia
1	Ea	Dr Structure, Tap, 15 inch
2	Ea	Dr Structure, 12 inch Tee Riser
1	Ea	Dr Structure, 36 inch Tee Riser
511	Ft	Underdrain, Pipe, 12 inch
42	Ft	Underdrain, Pipe, 15 inch
147	Ft	Underdrain, Pipe, 18 inch
68	Ft	Underdrain, Pipe, 4 inch
14	Ton	Hand Patching, GRT
62	Ton	HMA, 4E1, GRT
227	Ton	HMA, 5E1, GRT
6	Ea	Post, Mailbox
1600	Ft	Pavt Mrkg, Waterborne, 4 inch, White
200	Ft	Pavt Mrkg, Waterborne, 4 inch, Yellow
1600	Ft	Pavt Mrkg, Waterborne, 2nd Application, 4 inch, White
200	Ft	Pavt Mrkg, Waterborne, 2nd Application, 4 inch, Yellow
15	Ton	Riprap, Plain

REVISIONS:
01/08/2019 - Added HMA 4E1 & 5E1 quantities to "QUANTITIES THIS SHEET" table.

DATE	PROJ NUMBER	ENG	PROJ INGR	JTK	CADD	COUNTY	CITY/VILLAGE/TOWNSHIP	SCALE	H	V	NA	HORIZ DATUM	VERT DATUM
12/7/16	5025170120	OHM ADVISORS			SDH	MIDLAND	LARWIN CHARTER TWP.	1"=30'				Value	Value

MIDLAND COUNTY ROAD COMMISSION
EASTMAN ROAD SCRAP TIRE GRANT
CONSTRUCTION SHEET (STA 18+00 - STA 26+00)

11
OF 57



COPYRIGHT 2017 OHM ALL DRAWINGS AND WRITTEN MATERIALS APPEARING HEREIN CONSTITUTE THE ORIGINAL AND UNPUBLISHED WORK OF OHM AND THE SAME MAY NOT BE DUPLICATED, DISTRIBUTED, OR DISCLOSED WITHOUT PRIOR WRITTEN CONSENT OF OHM



DATE	PROJ NUMBER	ENG	PROJ MGR	CARD	COUNTY	CITY/VILLAGE/TOWNSHIP	SCALE	HORIZ. DATUM	VERT. DATUM
2/22/18	5025-174-21	CHM ADVISORS	JTK	SDH	MIDLAND	LARKIN CHARTER TWP.	N/A	N/A	Value

EASTMAN ROAD SCRAP TIRE GRANT

MIDLAND COUNTY ROAD COMMISSION

OF 57

Know what's below.
Call before you dig



STATION		BACK OF DRIVE OFFSET FROM ALI	OPENING WIDTH (@ BACK OF PAVED SHLDR)	PROPOSED DRIVEWAY SLOPE	RADIUS		HMA Approach	Aggregate Base, 6 inch	Approach, C II
					ENTER	EXIT			
		FT	FT	%	FT	FT	Ton	Syd	Ton
26+38	LT	31.0	38.0	-2.9%	10	10	-	-	6
26+73	RT	32.0	42.0	0.0%	40	25	-	-	8
27+91	LT	31.0	33.0	-5.5%	10	10	5	22	-
28+66	RT	32.0	38.0	0.9%	15	10	-	-	5
31+24	RT	30.0	33.0	1.6%	10	10	-	-	4
31+62	LT	20.0	27.0	-3.4%	15	15	2	6	-
34+00	LT	24.0	40.0	-9.3%	15	15	-	-	4
TOTALS							8	28	27

DRAWING PATH: P:\5000_5499\5025170120_Eastman_Road_Scrap_Tire_GrantDrawings\ChalPlans_Constr\70120CON_02.dwg Jan 08, 2019 - 1:03am

MATCH LINE STA 66+00

EASTMAN ROAD
(66' R.O.W.)

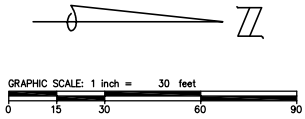



ARCHITECTS ENGINEERS PLANNERS

415 E Main St
Midland, MI 48640
P (989) 956-2020

OHM-ADVISORS.COM

MATCH LINE

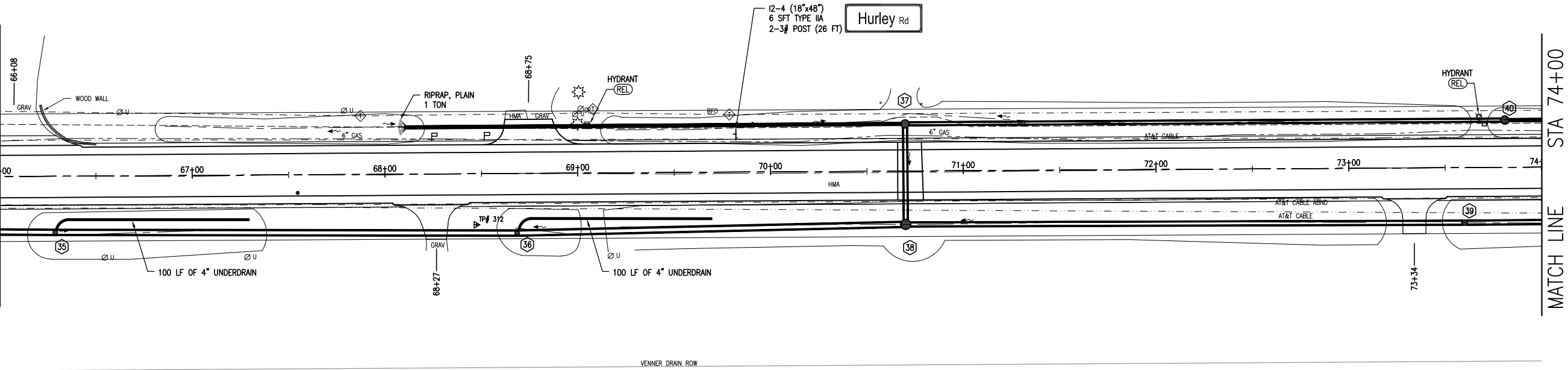

STA 74+00 MATCH LINE

STATION		BACK OF DRIVE OFFSET FROM ALI	OPENING WIDTH (@ BACK OF PAVED SHLDR)	PROPOSED DRIVEWAY SLOPE	RADIUS		HMA Approach	Aggregate Base, 6 inch	Approach, CI II
					ENTER	EXIT			
					FT	FT			
66+08	LT	21.0	68.0	-4.2%	30	30	-	-	5
68+27	RT	33.8	40.0	4.1%	15	10	-	-	6
68+75	LT	28.0	50.0	-10.2%	15	10	8	26	-
73+34	RT	34.0	34.0	3.8%	10	10	-	-	5
TOTALS							8	26	17

QUANTITIES THIS SHEET		
TOTAL	UNIT	DESCRIPTION
311	Cyd	Subbase, TDA
1016	Syd	Aggregate Base, 6 inch
61	Ton	Shoulder, CI II
1	Ea	Culv End Sect, 12 inch
471	Ft	Sewer, CI A, 30 inch, Tr Det A
52	Ft	Sewer, CI A, 24 inch, Tr Det B
3	Ea	Dr Structure Cover, Type G
2	Ea	Dr Structure, 48 inch dia
1	Ea	Dr Structure, 60 inch dia
1	Ea	Dr Structure, 24 inch Tee Riser
2	Ea	Dr Structure, 30 inch Tee Riser
278	Ft	Underdrain, Pipe, 12 inch
311	Ft	Underdrain, Pipe, 18 inch
330	Ft	Underdrain, Pipe, 24 inch
200	Ft	Underdrain, Pipe, 4 inch
13	Ton	Hand Patching, GRT
66	Ton	HMA, 4E1, GRT
226	Ton	HMA, 5E1, GRT
2	Ea	Post, Mailbox
26	Ft	Post, Steel, 3 lb
6	Sft	Sign, Type IIA
1600	Ft	Pavt Mrkg, Waterborne, 4 inch, White
200	Ft	Pavt Mrkg, Waterborne, 4 inch, Yellow
1600	Ft	Pavt Mrkg, Waterborne, 2nd Application, 4 inch, White
200	Ft	Pavt Mrkg, Waterborne, 2nd Application, 4 inch, Yellow
1	Ton	Riprap, Plain
2	Ea	Hydrant, Relocate, Case 2



DATE 12/1/18

PROJ NUMBER 502517-020

ENG OHM ADVISORS

PROJ MGR JTK

CITY/VILLAGE/TOWNSHIP LAMON CHARTER TWP.

COUNTY MIDLAND

CADD SCH

SCALE H: 1"=40' V: 1"=4'

HORIZ DATUM Value

VERT DATUM Value

MIDLAND COUNTY ROAD COMMISSION

EASTMAN ROAD SCRAP TIRE GRANT

CONSTRUCTION SHEET (STA 66+00 - STA 74+00)

REVISIONS:

01/08/2019	Added HMA 4E1 & 5E1 quantities to "QUANTITIES THIS SHEET" table.

COPYRIGHT 2017 OHM ALL DRAWINGS AND WRITTEN MATERIALS APPEARING HEREIN CONSTITUTE THE ORIGINAL AND UNPUBLISHED WORK OF OHM AND THE SAME MAY NOT BE DUPLICATED, DISTRIBUTED, OR DISCLOSED WITHOUT PRIOR WRITTEN CONSENT OF OHM

DRAWING PATH: P:\5000_5499\5025170120_Eastman_Road_Scrap_Tire_GrantDrawings\ChalPlans_Constr\70120CON_02.dwg Jan 08, 2019 - 1:03pm

MATCH LINE STA 90+00

EASTMAN ROAD

(66' R.O.W.)

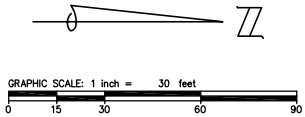



ARCHITECTS ENGINEERS PLANNERS

415 E Main St
Midland, MI 48640
P (989) 956-2020

OHM-ADVISORS.COM

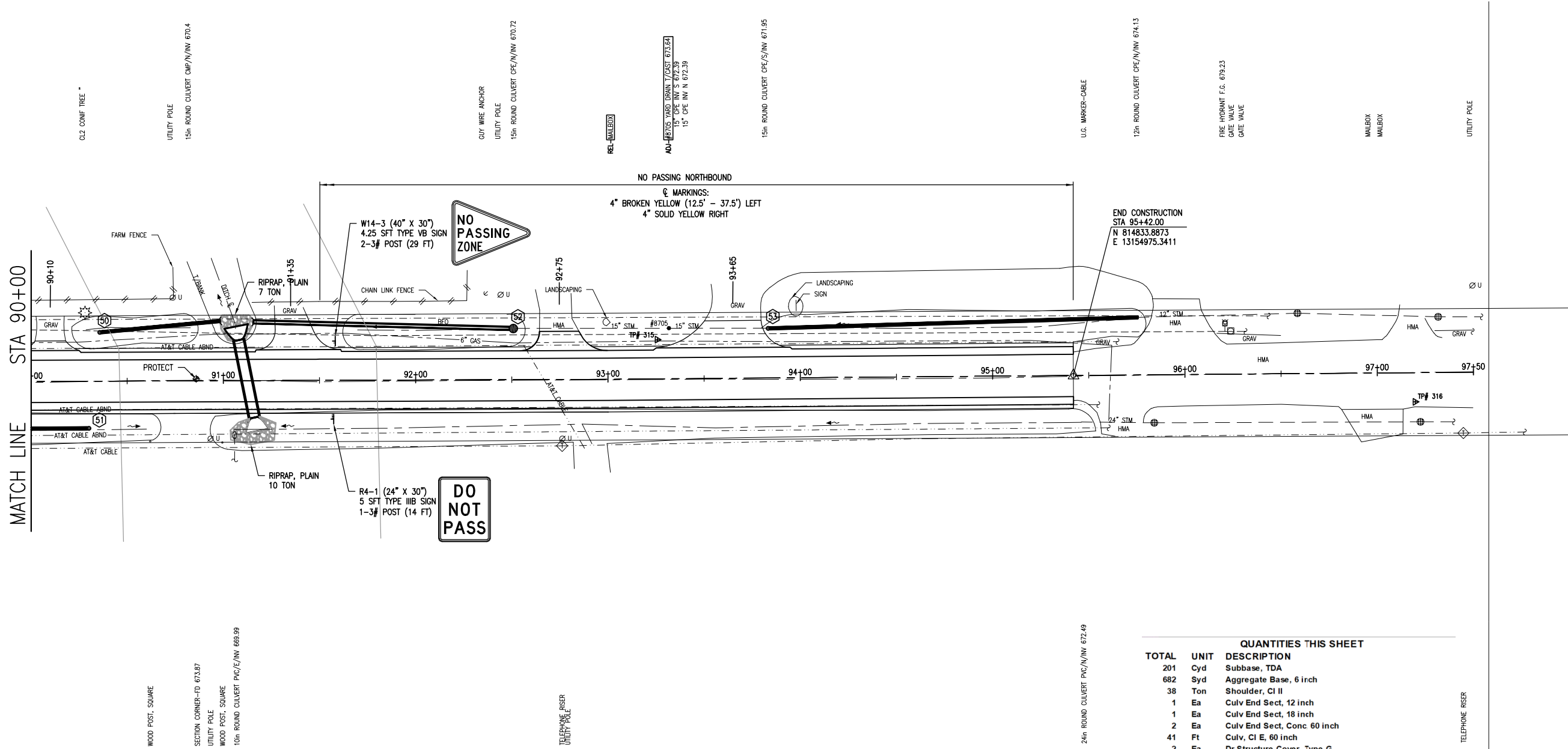

STATION		BACK OF DRIVE OFFSET FROM ALI	OPENING WIDTH (@ BACK OF PAVED SHLDR)	PROPOSED DRIVEWAY SLOPE	RADIUS		HMA Approach	Aggregate Base, 6 inch		Approach, C II
					ENTER	EXIT		Ton	Syd	Ton
90+10	LT	21.0	31.0	-6.4%	15	15	-	-	-	2
91+35	LT	34.0	45.0	-6.4%	15	10	-	-	-	8
92+75	LT	25.0	45.0	0.5%	15	10	6	22	-	-
93+65	LT	30.0	72.0	-1.7%	15	35	-	-	-	11
TOTALS							6	22		22

QUANTITIES THIS SHEET		
TOTAL	UNIT	DESCRIPTION
201	Cyd	Subbase, TDA
682	Syd	Aggregate Base, 6 inch
38	Ton	Shoulder, C I II
1	Ea	Culv End Sect, 12 inch
1	Ea	Culv End Sect, 18 inch
2	Ea	Culv End Sect, Conc 60 inch
41	Ft	Culv, C I E, 60 inch
2	Ea	Dr Structure Cover, Type G
1	Ea	Dr Structure, 24 inch dia
1	Ea	Dr Structure, 48 inch dia
2	Ea	Dr Structure, 12 inch Tee Riser
285	Ft	Underdrain, Pipe, 12 inch
135	Ft	Underdrain, Pipe, 18 inch
18	Ton	Hand Patching, GRT
41	Ton	HMA, 4E1, GRT
154	Ton	HMA, 5E1, GRT
1	Ea	Post, Mailbox
43	Ft	Post, Steel, 3 lb
5	Sft	Sign, Type IIIB
5	Sft	Sign, Type VB
1084	Ft	Pavt Mrkg, Waterborne, 4 inch, White
528	Ft	Pavt Mrkg, Waterborne, 4 inch, Yellow
1084	Ft	Pavt Mrkg, Waterborne, 2nd Application, 4 inch, White
528	Ft	Pavt Mrkg, Waterborne, 2nd Application, 4 inch, Yellow
17	Ton	Riprap, Plain
1	Ea	Monument Box
1	Ea	Monument Preservation



REVISIONS:
01/08/2019 - Added HMA 4E1 & 5E1 quantities to "QUANTITIES THIS SHEET" table.

DATE	PROJ NUMBER	ENG	PROJ INGR	COUNTY	CITY/VILLAGE/TOWNSHIP	SCALE	H	V	VERT DATUM
12/1/18	502517-020	OHM ADVISORS	JTK	MIDLAND	LAWRENCE TWP.	1"=40'	1"=40'		Value

MIDLAND COUNTY ROAD COMMISSION
EASTMAN ROAD SCRAP TIRE GRANT
CONSTRUCTION SHEET (STA 90+00 - P.O.E.)

Midland County Road Commission

Alternate HMA Items

Letting Date: Thursday, January 24, 2019 1:00 PM

Contract ID: 5025-17-0120ALT
Location: Eastman Road
Description: ALTERNATE HMA

Project Number: 5025-17-0120ALT
Estimate Number: 1
Project Type: Miscellaneous
Location: Eastman Road

Project Engineer: T. Palmer
Date Created: 1/8/2019
Fed/State #:
Fed Item:
Control Section:

Description: ALTERNATE HMA

Instructions to Bidders:	IMPORTANT NOTICE:
---------------------------------	--------------------------

Please provide pricing to the following items. These items are to be considered an Alternate to similar bid items and not included in total cost bid for project. These items may replace similar bid items as directed by the Engineer.

Pay Item	Description	Quantity	Units	Unit Price		Bid Amount	
				Dollars	Cts	Dollars	Cts
5010025	Hand Patching	166	Ton				
5010050	HMA, 4E1	661	Ton				
5010056	HMA, 5E1	2,382	Ton				
5010061	HMA Approach	224	Ton				
<div style="text-align: right;">Total Bid:</div>							

MIDLAND COUNTY ROAD COMMISSION

SPECIAL PROVISION
FOR
DR STRUCTURE, __ INCH TEE RISER

OHM:JTK

1 of 1

01-08-19

a. Description. This work consists of installing a Drainage Structure, __ inch Tee Riser (size as specified) at the location and elevation as shown on the plans.

b. Materials. Provide materials in accordance with Sections 902 and 909 of the MDOT 2012 Standard Specifications for Construction, except as modified herein.

Material for the plastic tee and extension pipe may be smooth-lined corrugated polyethylene pipe (CPE) or Polyvinyl Chloride (PVC) in accordance to section 909.06 of the MDOT 2012 Standard Specifications for Construction. Vertical riser pipe shall be solid (non-perforated).

c. Construction. Construction shall be in accordance with section 403 and 404 of the MDOT 2012 Standard Specifications for Construction, except as modified herein.

Install a plastic tee at locations shown on plans and the appropriate length of vertical extension pipe to match the rim elevations per plan. Connect tee to underdrain and extension pipe with soil tight joints.

Install East Jordan domed drain grates at the top of the extension pipe at the rim elevation shown on the plans. The diameter of the grate shall match the tee diameter up to 24". For 30" and 36" tee risers, the vertical shall be reduced to 24".

Electronically submit shop drawings, at least 14 calendar days prior to starting the work, showing the plastic tee, extension pipe, and grate cover, including the watertight joints. Do not begin work until the shop drawings are approved.

d. Measurement and Payment. The completed work, as described, will be measured and paid for at the contract unit price using the following pay items:

Pay Item	Pay Unit
Dr Structure, __ inch Tee Riser.....	Each

The unit price for **Dr Structure, __ inch Tee Riser** includes all labor, equipment, and materials necessary for the installation of a plastic tee, extension pipe, connections, and drain grates.